

- FFDL** • AC Motor • Low Energy • Backward Inclined Fan
FFDLRA • AC Motor • Low Energy • Room Side Replaceable Filter & Motor • Backward Inclined Fan

FFDL

Note: Items in **bold** designate standard offering

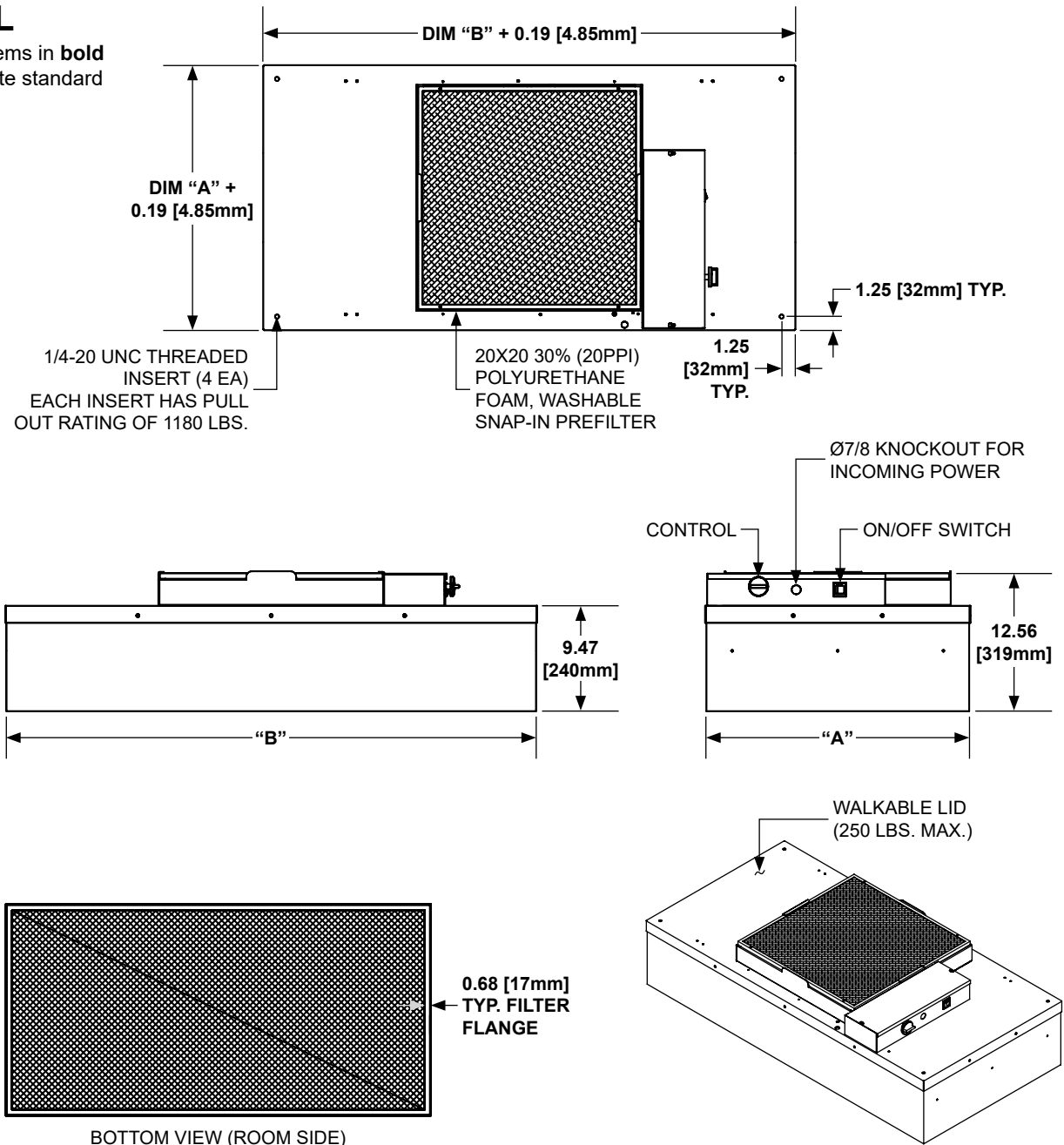

Filter Size (OD)		Nominal Filter Size
DIM "A" in (mm)	DIM "B" in (mm)	
<input type="checkbox"/> 23.63 (600)	47.63 (1210)	2 X 4
<input type="checkbox"/> 23.63 (600)	35.63 (905)	2 X 3
<input type="checkbox"/> 23.63 (600)	23.63 (600)	2 X 2
<input type="checkbox"/>		**Other

** Contact Titus to Ensure Size Availability.

HEPA filter, Pre-filter & Lid assembly

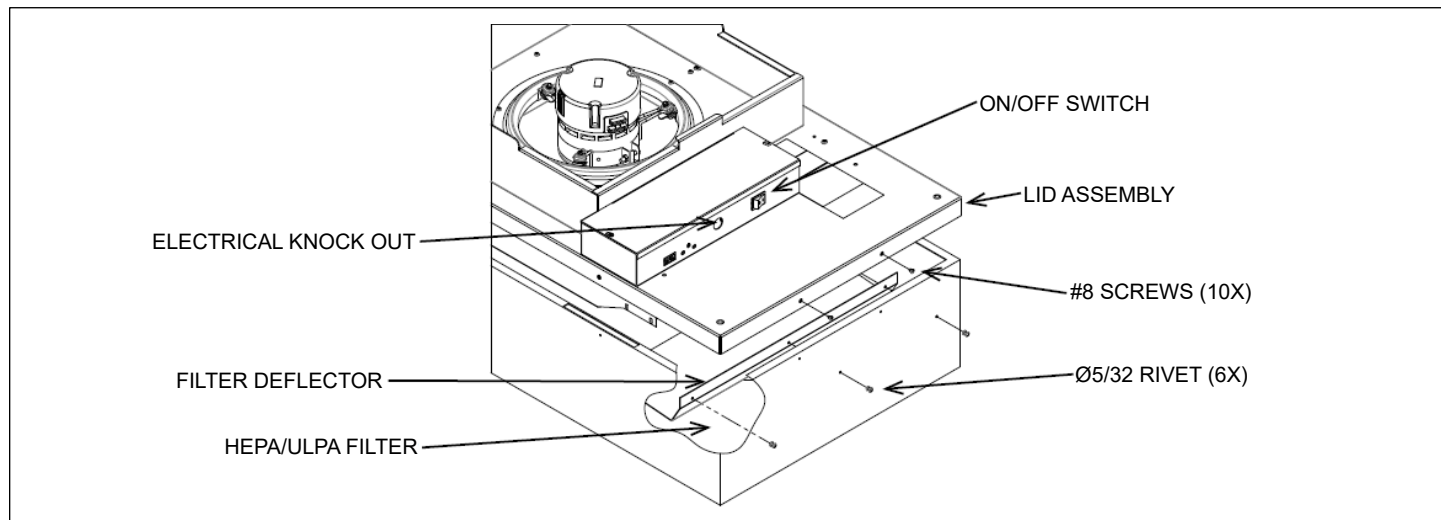

Challenge/Concentration Port Detail

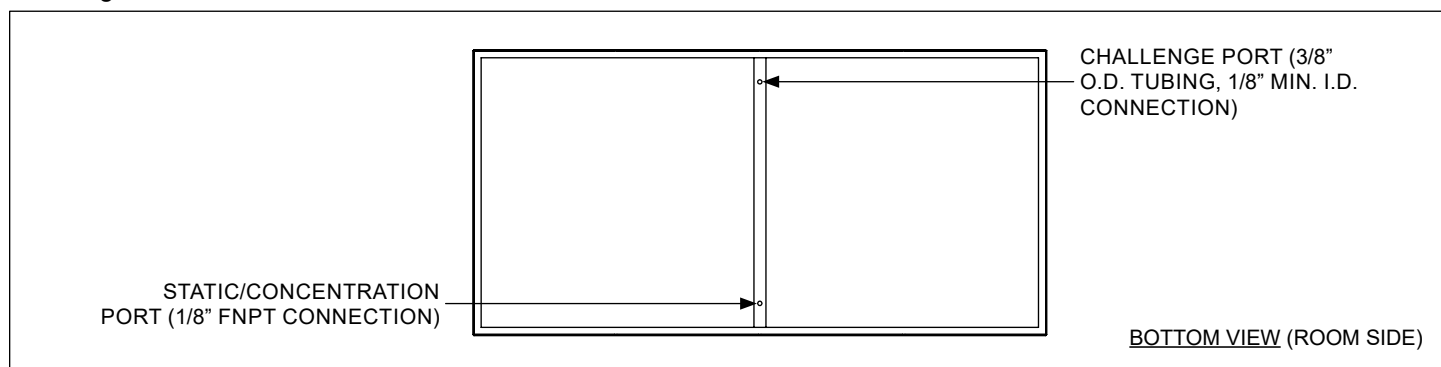

Basic Unit Configuration

Check ☒ if provided.

Motor

Three Speed AC Motor with Backward Inclined Wheel

☐ **120V, 60 Hz, 1 PHASE, 1.80 FLA**☐ 277V, 60 Hz, 1 PHASE, 0.80 FLA

Filter

☐ **HEPA 99.99% @ 0.3 Micron UL 900**☐ ULPA 99.9995% @ 0.12 Micron UL 900☐ Other _____

Control

Solid State Speed Control - Variable Speed Switch

Housing Finish

☐ **Mill Finish Aluminum (04)**☐ Powder Coat Paint - White (26)☐ 304 Stainless Steel (SS2)

Screen Finish

☐ Mill Finish Aluminum (04)☐ Powder Coat Paint - White (26)☐ 304 Stainless Steel (SS1)

Options (Select multiple if applicable)

☐ Continuous Filter Monitoring (CFM)
[0-10V Output Signal]☐ Insulation - Applied to Unit Top & Sides (INS)☐ Challenge Ports (CHP)☐ Surface Mount Frame (SMA)

Certification

☐ **UL 507 Listed (E152685)**Note: Items in **bold** designate standard offering

FFDLRA

Note: Items in **bold** designate standard offering

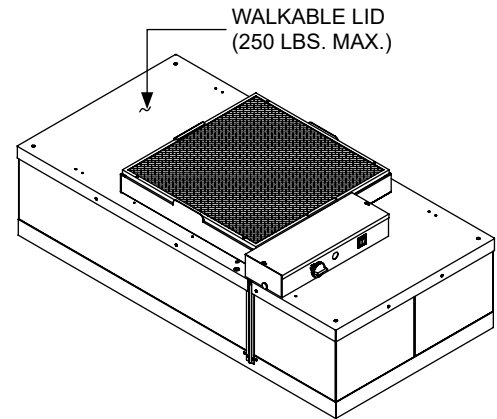
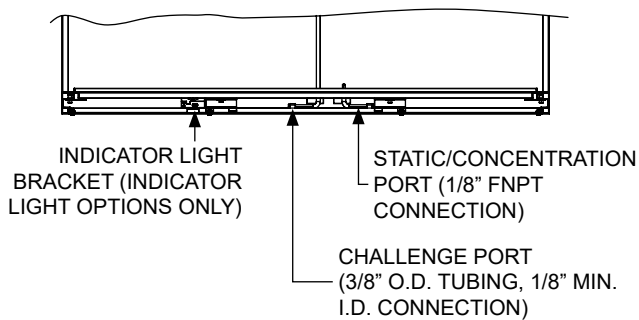
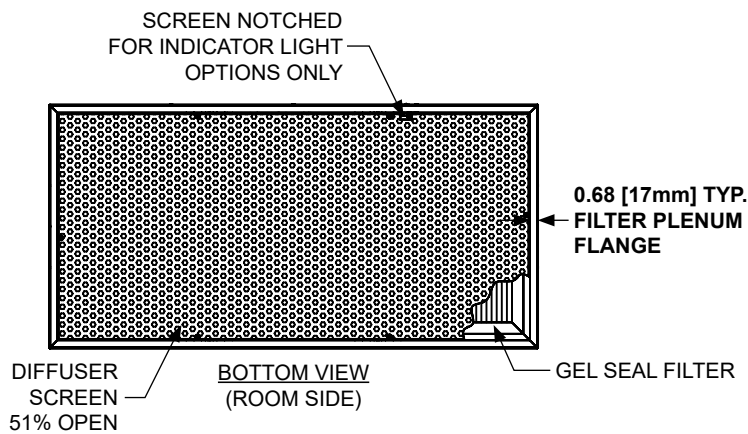
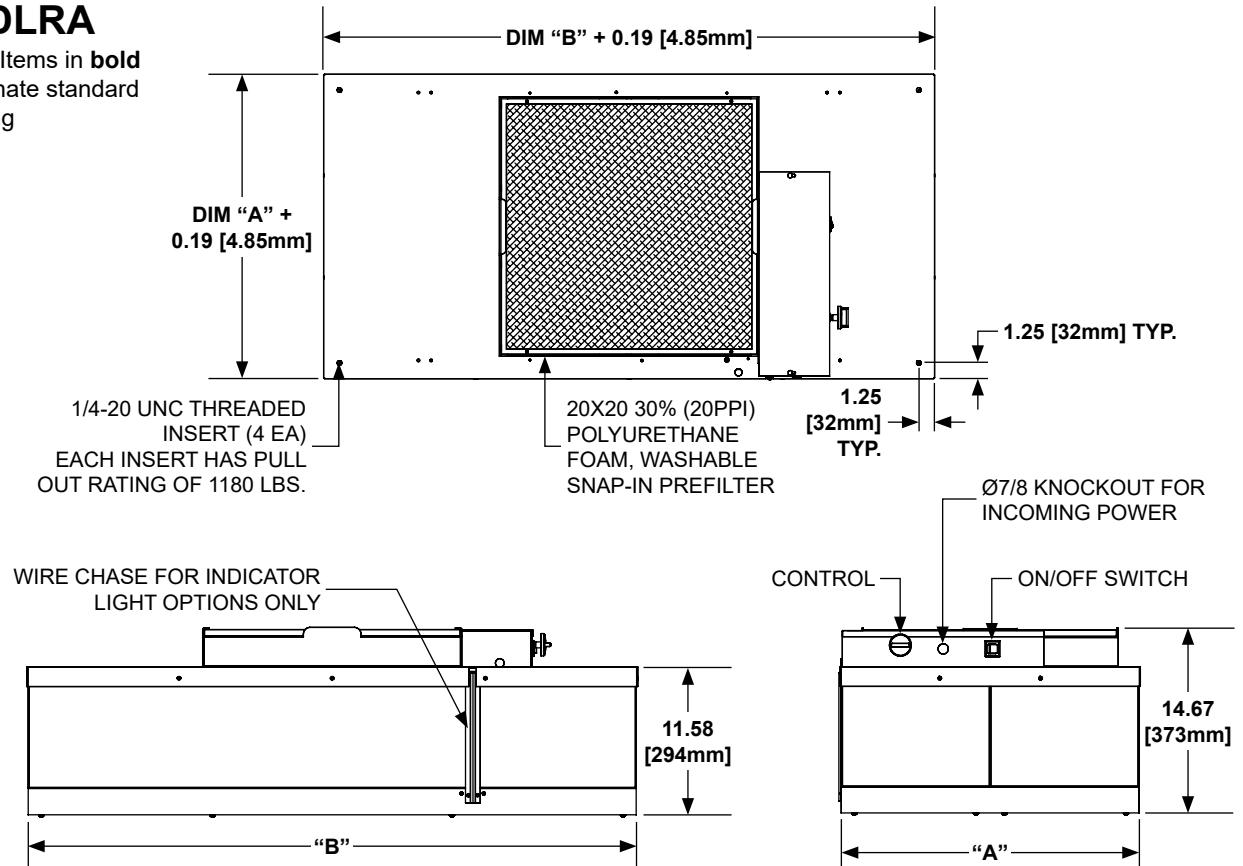

Housing Size (OD)		Nominal Filter Size
DIM "A" in (mm)	DIM "B" in (mm)	
<input type="checkbox"/> 23.63 (600)	<input type="checkbox"/> 47.63 (1210)	2 X 4
<input type="checkbox"/> 23.63 (600)	<input type="checkbox"/> 35.63 (905)	2 X 3
<input type="checkbox"/> 23.63 (600)	<input type="checkbox"/> 23.63 (600)	2 X 2
<input type="checkbox"/>		**Other

**** Contact Titus to Ensure Size Availability.**

Challenge/Concentration Port Detail

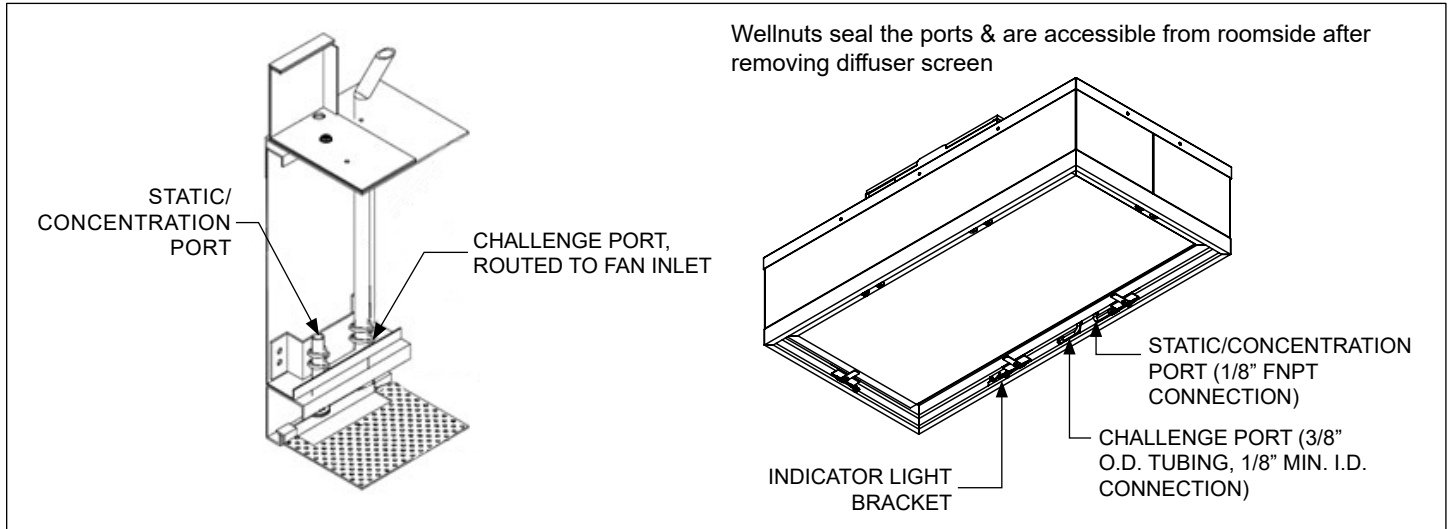

HEPA Filter and Motor Replacement Detail

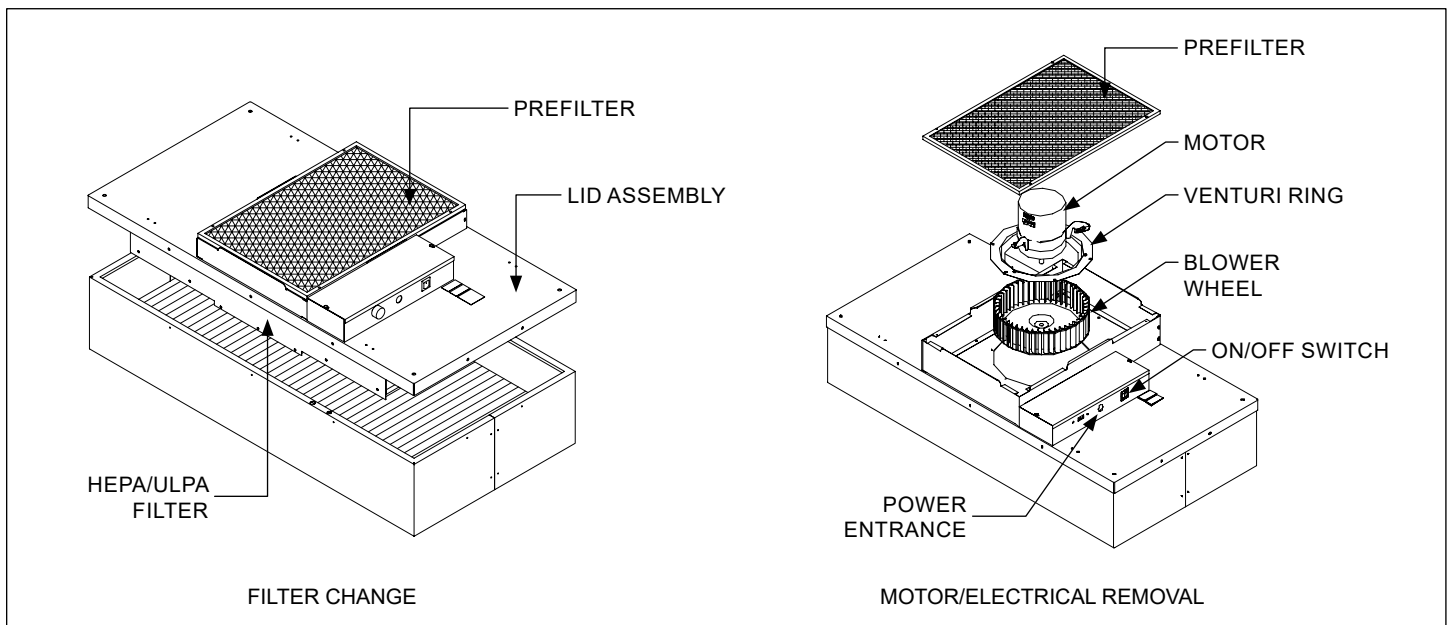

Basic Unit Configuration

Check ☒ if provided.

Housing Style

- ☐ FFDLRA - Filter, Baffle, & Motor Roomside Removable

Motor

Three Speed AC Motor with Backward Inclined Wheel

- ☐ **120V, 60 Hz, 1 PHASE, 1.80 FLA**
☐ 277V, 60 Hz, 1 PHASE, 0.80 FLA

Filter

- ☐ **HEPA 99.99% @0.3 Micron UL 900**
☐ ULPA 99.9995% @0.12 Micron UL 900
☐ Other _____

Control

Solid State Speed Control - Variable Speed Switch

Housing Finish

- ☐ **Mill Finish Aluminum (04)**
☐ Powder Coat Paint - White (26)
☐ 304 Stainless Steel (SS2)
 [Unit Height Increases by 3/8"]

Screen Finish

- ☐ **Mill Finish Aluminum (04)**
☐ Powder Coat Paint - White (26)
☐ 304 Stainless Steel (SS1)

Options (Select multiple if applicable)

- ☐ Motor Run Indicator Light - Green (AIL)
 (ON = Motor Running; OFF = Motor Failure)
☐ Filter Load Indicator Light - Red (FLI)
 (ON = Time to Change Filter)
☐ Continuous Filter Monitoring (CFM)
 [0-10V Output Signal]
☐ Insulation - Applied to Unit Top & Side (INS)
☐ Filter Shipped Separately from Unit (FSL)
☐ Surface Mount Frame (SMA)

Certification

- ☐ **UL 507 Listed (E152685)**

Note: Items in **bold** designate standard offering

Inlet Adapter Accessory Detail

Duct Collar Dimensions

Model	Dim A	Dim B	Diameter	Unit Size	Part Number
FFDBR/A	20"	20"	10"	2X4	11231-001
FFDBR/A	20"	20"	12"	2X4	11231-002

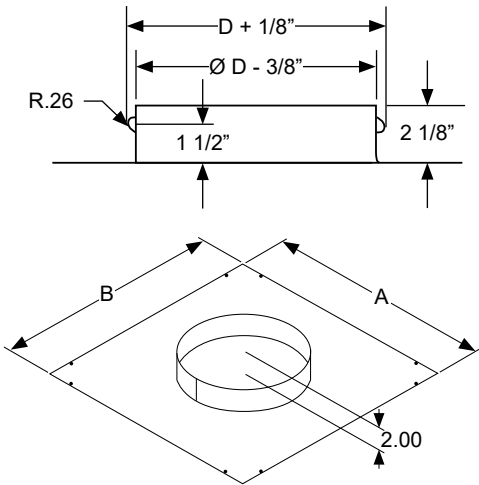

Surface Mount Adapter Accessory Detail

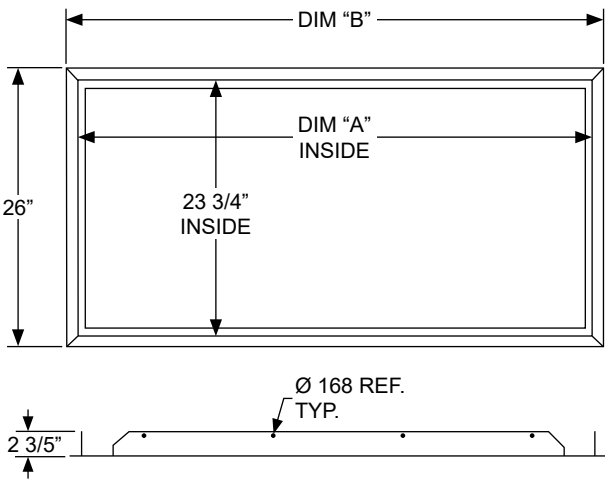

Unit Size	A	B
24"x24"	23 3/4	26
48"x24"	47 3/4	50

